

2 Fibers Distribution Box

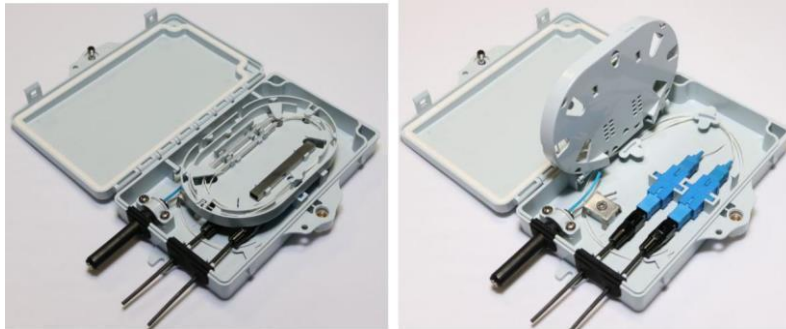

Description

The equipment is used as a termination point for the feeder cable to connect with drop cable in FTTx communication network system. The fiber splicing, splitting, distribution can be done in this box, and meanwhile it provides solid protection and management for the FTTx network building.

Features

- ✓ Material: PC+ABS, wet-proof, water-proof, dust-proof, anti-aging, protection level up to IP65.
- ✓ Clamping for feeder cable and drop cable, fiber splicing, fixation, storage, distribution.
- ✓ Cable, pigtails, patch cords are running through own path without disturbing each other, cassette type SC adapter installation, easy maintenance.
- ✓ Distribution panel can be flipped up, feeder cable can be placed in a cup-joint way, easy for maintenance and installation.

Specifications and Dimensions:

Environmental Requirement

Working temperature : $-40^{\circ}\text{C} \sim +85^{\circ}\text{C}$

Relative humidity : $\leq 85\%$ ($+30^{\circ}\text{C}$)

Atmospheric pressure : $70\text{KPa} \sim 106\text{Kpa}$

Main Technical Data

Insertion loss : $\leq 0.2\text{dB}$

UPC return loss : $\geq 50\text{dB}$

APC return loss : $\geq 60\text{Db}$

Life of insertion and extraction : > 1000 times

Thunder-proof Technical Data

The grounding device is isolated with the cabinet, isolation resistance is no less than 2 104 MΩ/500V (DC) ; IR≥2 104 MΩ/500V

The withstand voltage between grounding device and cabinet is no less than 3000V (DC) /min, no puncture, no flashover; U≥3000V

Configuration table:

| Description | Size (Pic 1) | Max Capacity | | | Installation Size (Pic 2) |
|------------------|--------------|--------------|----|--------|---------------------------|
| | A*B*C(mm) | SC | LC | PLC | D*E (mm) |
| Distribution Box | 167*102*31 | 2 | 4 | 4 (LC) | 159*80 |

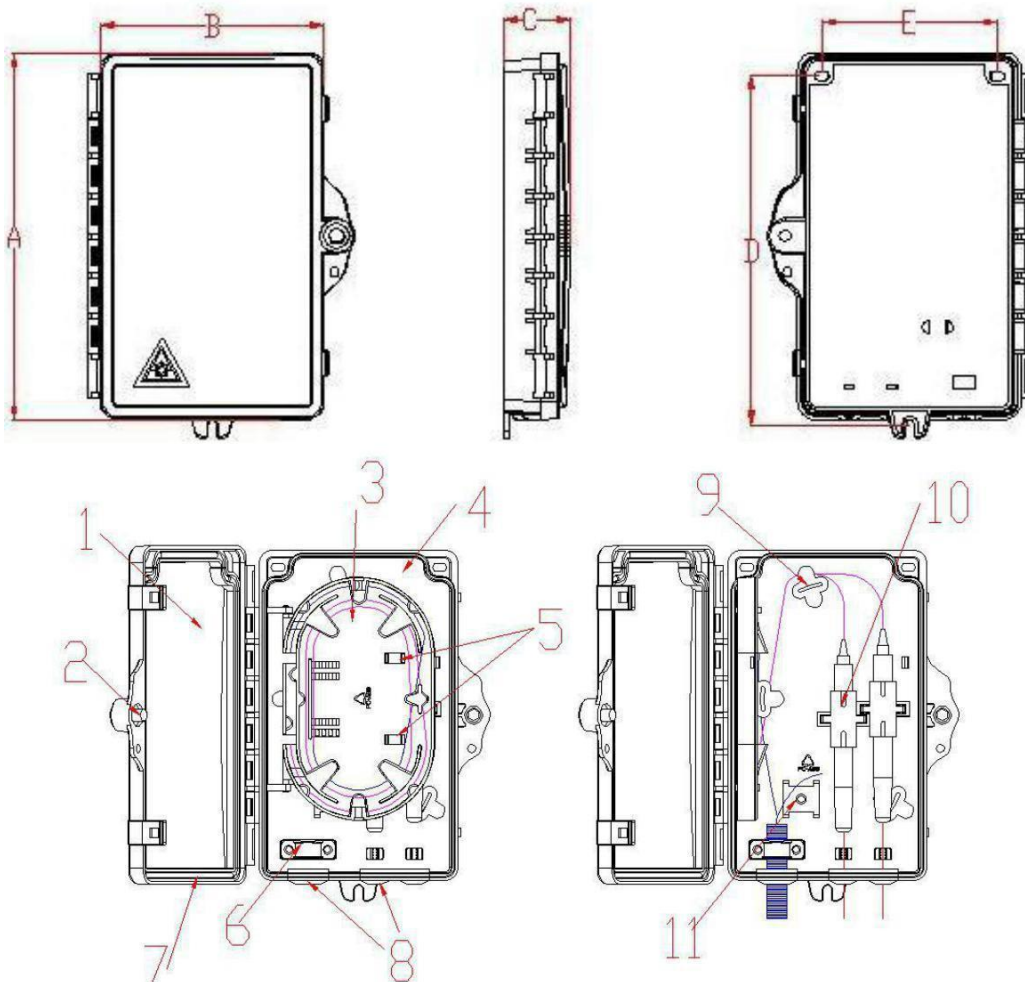

Ordering Information

| Part Number | Description |
|-------------|---------------------------|
| FTTH-BOX-2F | 2 Fibers Distribution Box |

Rev. 1 – March 2018